

DATE \_\_\_\_\_



"MAC200RII" Specifications  
(120V)

Ver.200806

## Specification List

Model		MAC200RII
UL file number		UL E341420
Typical Applications		Aeration, etc.
Rated	Voltage Range and Frequency	AC 120 V $\pm$ 10 V 60 Hz
	Proper Pressure Range	2.9 PSI $\pm$ 20%
		20 kPa $\pm$ 20%
	Insulate Class	A
Rating	Continuous	
Exterior	Dimensions	7 <sup>1</sup> / <sub>8</sub> " X 11 <sup>7</sup> / <sub>8</sub> " X 7 <sup>3</sup> / <sub>4</sub> "
		180 mm X 300 mm X 198 mm
	Color	White
	Weight	approx. 20 lbs (9 kg)
	Outlet Pipe Size	O.D. 1" ( $\phi$ 26 mm)
Normal Operation and Performance	Power Cord	6'2" (1880 mm)
	Input Voltage	AC 120V 60 Hz
	Normal Pressure	2.9 PSI (20 kPa)
	Current	2.5 A or less
	Electricity Consumption	155 W
	Air Flow Volume	7.1 CFM (6.39 CFM more)
		200 L/min (180 L/min or more)
	Noise Level (at 3 <sup>1</sup> / <sub>4</sub> ft)	55 dBA or less
	Temperature Increase (at 77 °F)	Solenoid :135 °F (75 °C) or less, Surface : 81 °F (45 °C) or less
	Insulation Resistance	1.0 M $\Omega$ or more (DC 500 V)
Withstand Voltage	AC 1500 V - 1 min	
Environment	Aging Performance	Initial performance should remain
	Temperature Range	-4 °F to 104 °F (-20 °C to 40 °C)
	Humidity	90% or less
	Installation Orientation	Install horizontally
	Other	No oil, corrosive gas, nor explosive gas

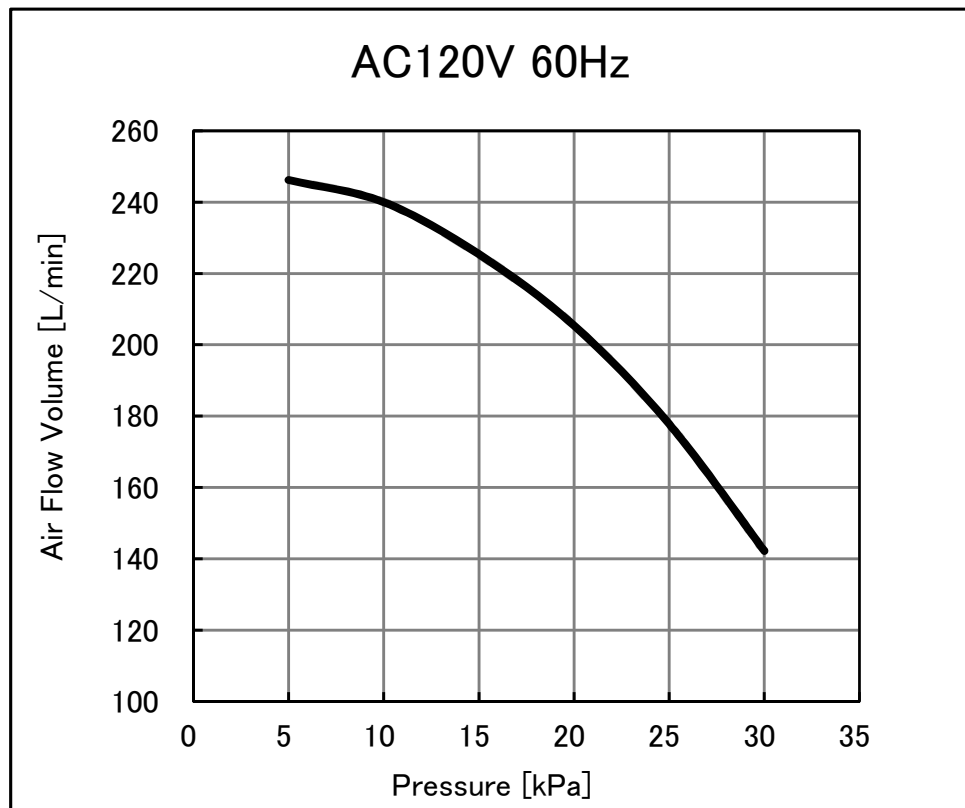
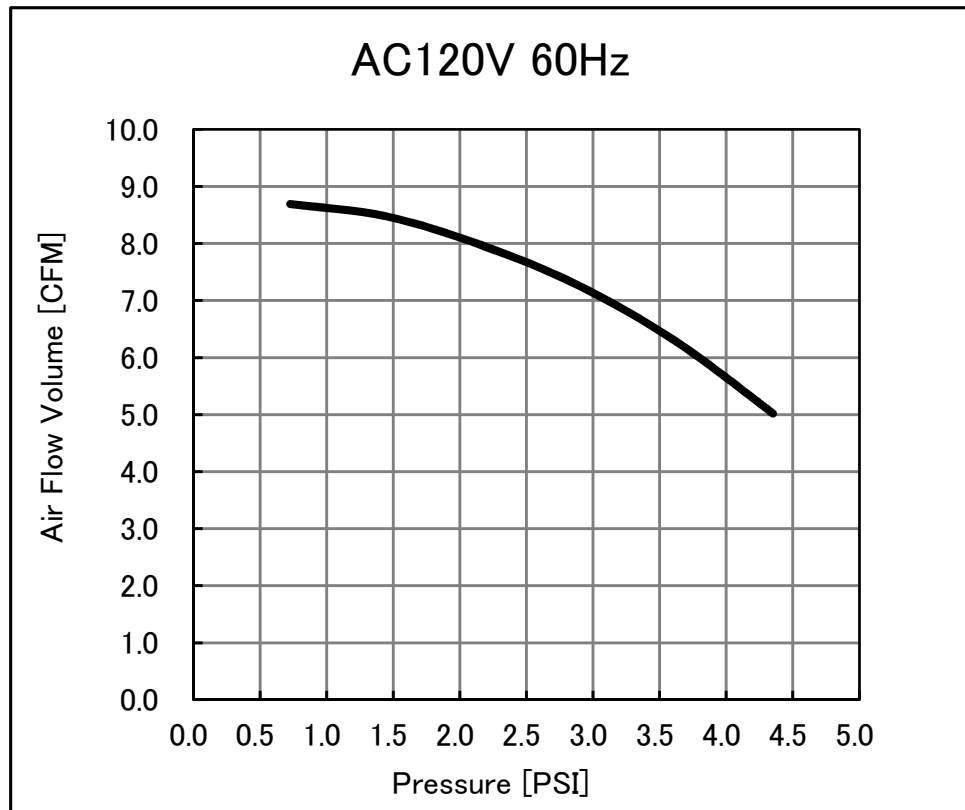

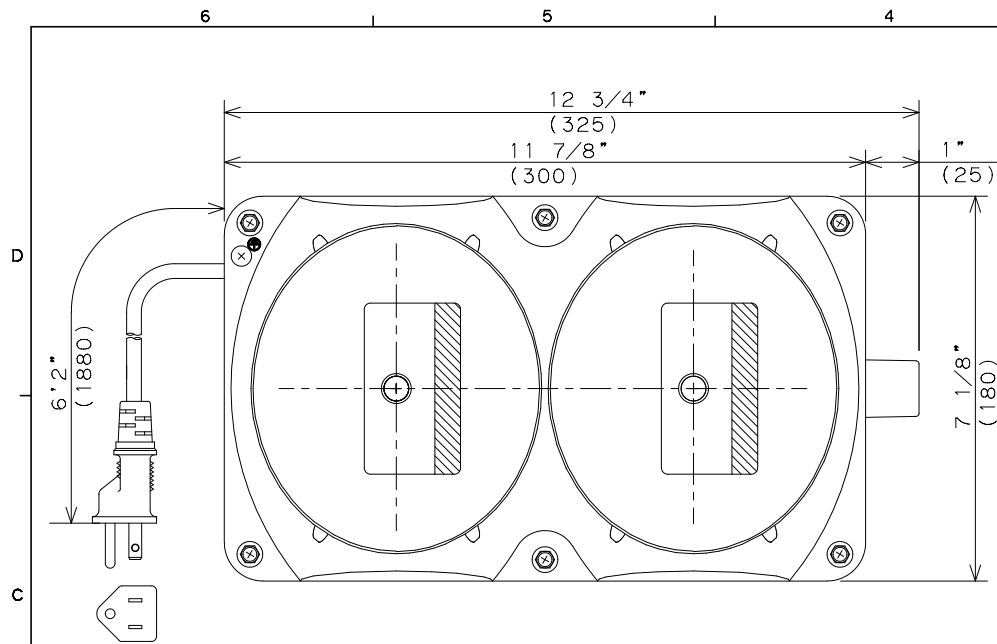

Specifications			
Model		MAC150RII	MAC200RII
Air Flow Volume	CFM	5.3	7.1
	L/min	150	200
Normal Pressure	PSI	2.9	
	kPa	20	
Rated Voltage	V	AC120	
Frequency	Hz	60	
Power Consumption	W	115	155
Weight	lbs.	Approx. 20	
	kg	Approx. 9	
Outlet Pipe Diameter	inch	1"	
Power Cord Length	inch	6'2"	
UL file number		E341420	
Country of origin		Japan	

**Installation / Operation & Maintenance Notes:**

- Install blower on leveled solid base. Ensure adequate ventilation and protect against direct sunlight.
- Inspect and clean internal air filter once every 3 months.
- Recommend diaphragm / valve assembly replacement once every 12 months.  
(Note: a torn diaphragm will trigger the Automatic-Stop function.)
- Please make sure to follow the instruction manual.

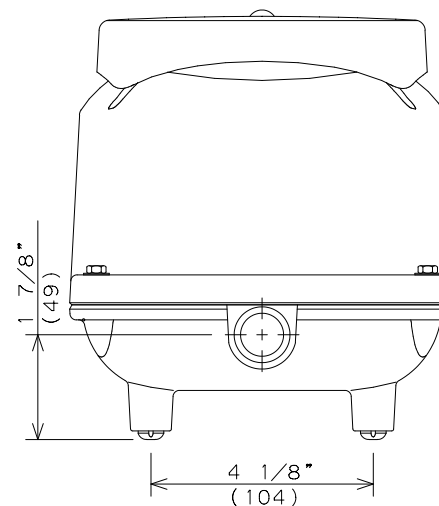
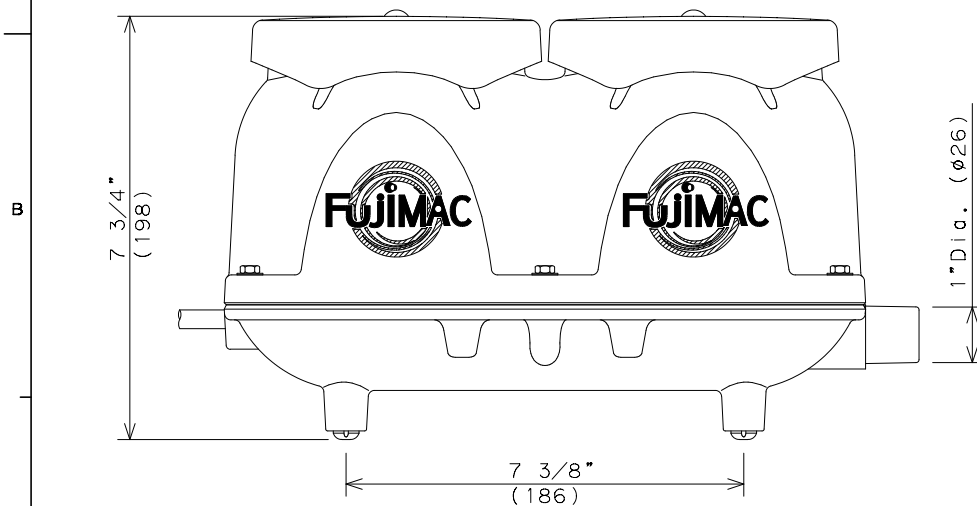

All drawing measurements in inches(mm).



TITLE MAC150RII/200RII	APPROVAL DATE 05-10-2017	
	SIZE A3	SCALE 2:5
<b>Fujimac</b>	DWG NO T20009Z1-H3	